

RY907000FI QUICK REFERENCE GUIDE

⚠ WARNING:

This Quick Reference Guide is not a substitute for reading the operator’s manual. To reduce the risk of injury or death, user must read and understand operator’s manual before using this product. All page references refer to the operator’s manual.

IMPORTANT!

⚠ WARNING:

Do not connect to a building’s electrical system unless the generator and transfer switch have been properly installed and the electrical output has been verified by a qualified electrician. The connection must isolate the generator power from utility power and must comply with all applicable laws and electrical codes.

⚠ DANGER

Using a generator indoors CAN KILL YOU IN MINUTES. Generator exhaust contains carbon monoxide. This is a poison you cannot see or smell.



NEVER use inside a home or garage, EVEN IF doors and windows are open.



Only use OUTSIDE and far away from windows, doors, and vents.

TOOLS NEEDED

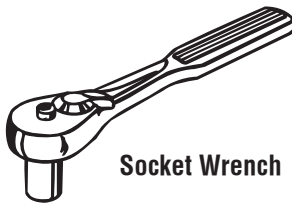

Socket Wrench

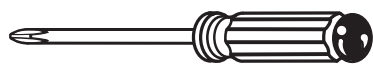

Phillips Screwdriver



Combination Wrench

FIRST TIME ASSEMBLY

1 Install the feet (see page 11).

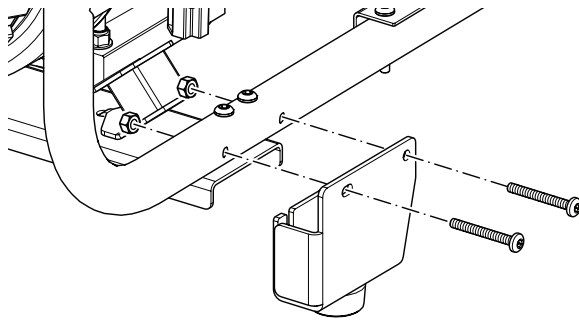

2 Install the wheels (see page 12).

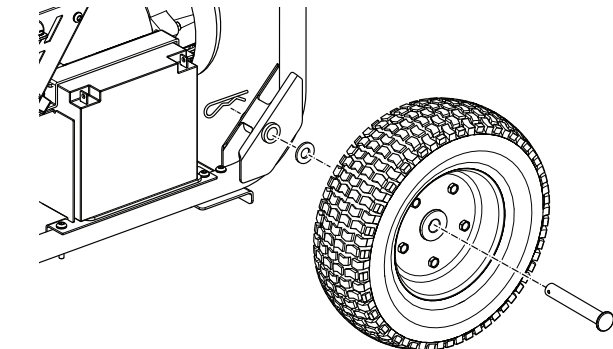

3 Connect and charge the battery (see pages 12 and 17).

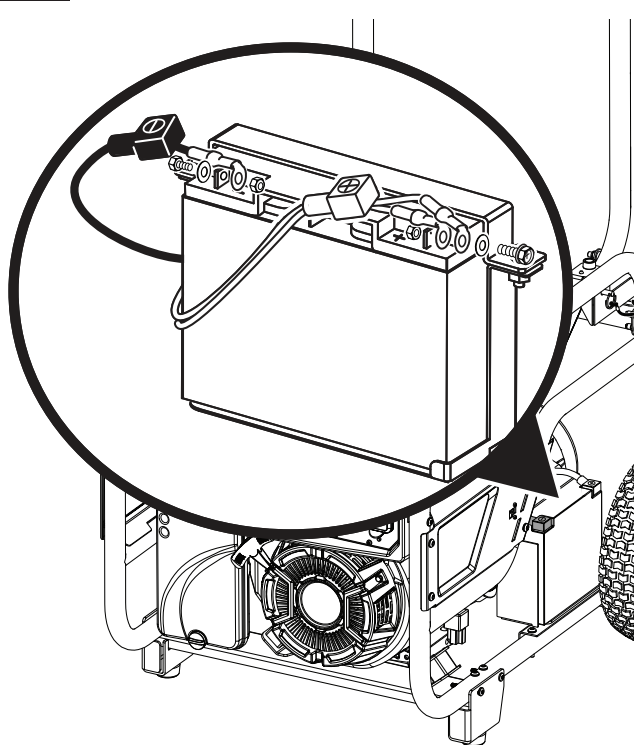

4 Raise and secure the handle (see page 13).

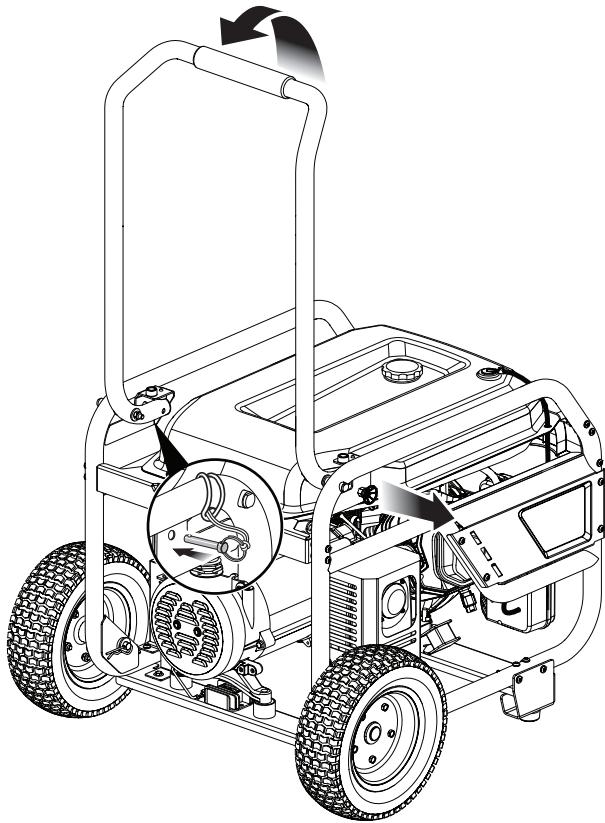

5 Add entire bottle of lubricant provided to the generator (see page 13).

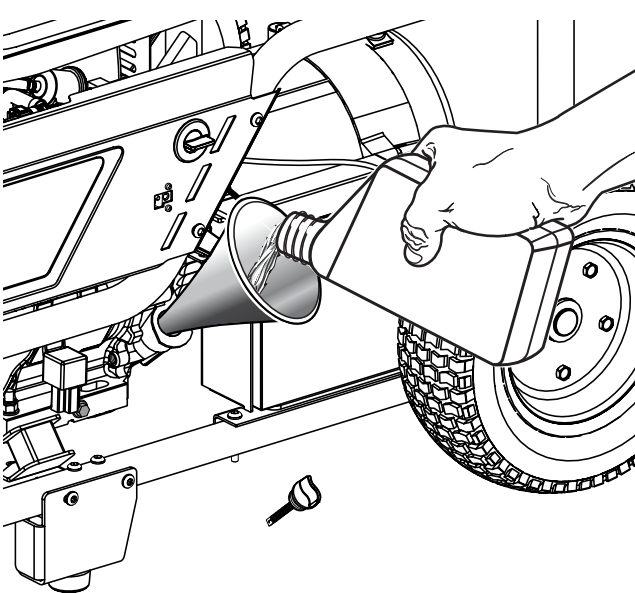

Set unit on flat surface so engine is level. Remove dipstick, wipe clean, put back in hole (but don't screw in) and check lubricant level.

STARTING THE UNIT

1 Add fuel (see page 14).

NOTICE:

Do not use E15 or E85 fuel in this product. It is a violation of federal law and will damage the unit and void your warranty. Only use unleaded gasoline containing up to 10% ethanol.

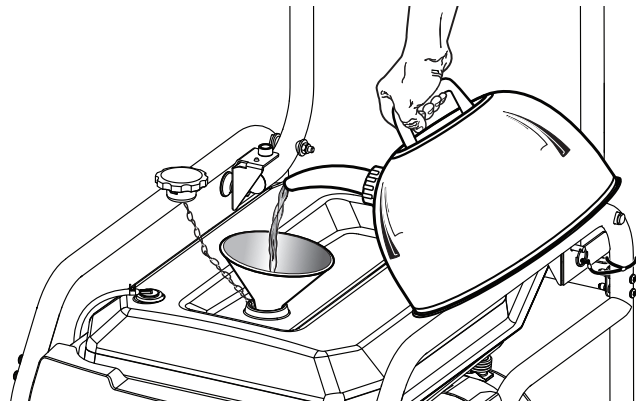

This is a 4-cycle engine. Do not mix fuel and lubricant together.



Mix fuel stabilizer with gasoline according to manufacturer's directions prior to filling the tank.

2 Turn the fuel valve to ON and put the engine switch in the ON position, wait 30 seconds (see page 15).

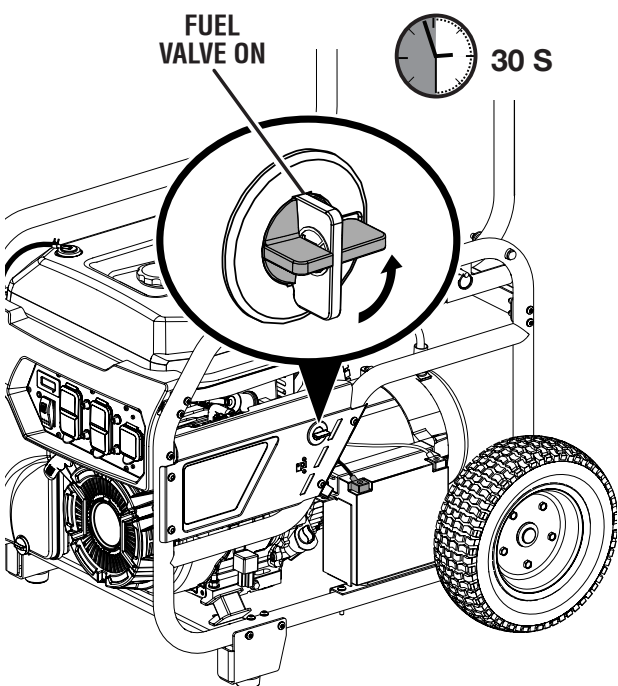

3 Slide the lock button down and push the engine switch to the START position. Engine can also be started by pulling the recoil starter grip until the engine runs. The battery may require charging before the generator can be started using either the engine switch or the recoil starter. (See page 15)

LOCK BUTTON

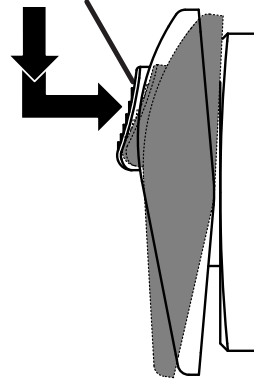

OR PULL RECOIL STARTER TO START

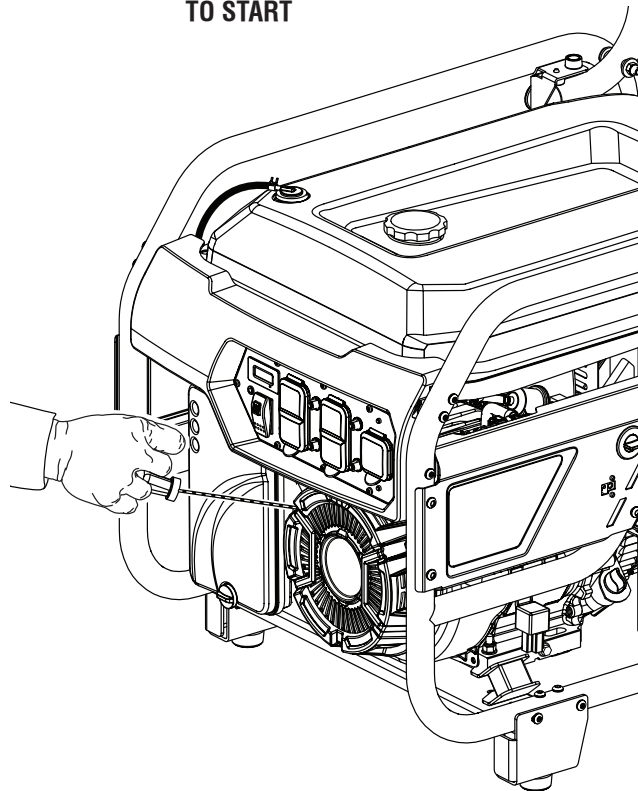

NOTICE:

The battery may require charging before the generator can be started using either the engine switch or the recoil starter.

STOPPING THE UNIT

1 Turn the engine switch to the OFF position (see page 15).

ENGINE SWITCH (OFF POSITION)

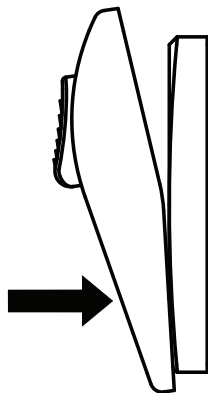

2 Turn the fuel valve to the OFF position (see page 15).

FUEL VALVE OFF

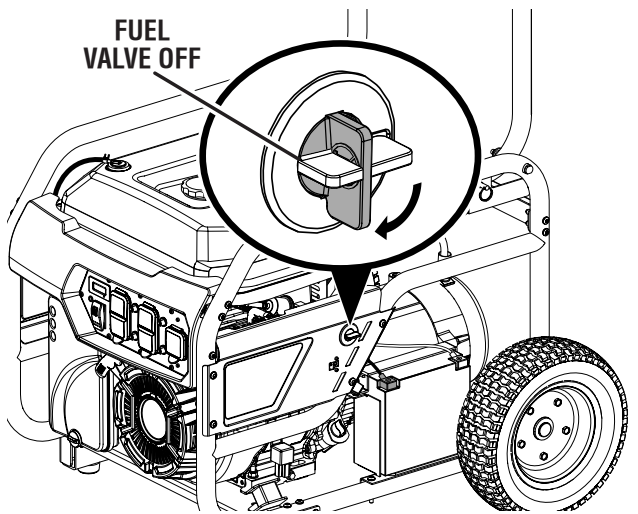

USING THE GENERATOR

1 Connect devices to be powered by generator by following the steps below (see pages 8-9).

- Make sure the generator can supply enough continuous (running) and surge (starting) watts for the items you will power at the same time. See page 9 for how to calculate total amount of power needed.
- Start the generator with nothing connected.
- Plug in and turn on the first load, preferably the largest load you have.
- Permit the generator output to stabilize (engine runs smoothly and attached device operates properly).
- Plug in and turn on the next load.
- Again, permit the generator to stabilize.
- Repeat previous two steps for each additional load.

IMPORTANT: Never add more loads than the generator capacity. Take special care to consider surge loads in generator capacity. (See pages 8-9.)

STORING THE UNIT

1 When preparing to store the generator, allow the unit to cool for 30 minutes, then follow the guidelines listed on page 18.

TROUBLESHOOTING

PROBLEM	POSSIBLE CAUSE	SOLUTION
Engine will not start.	Battery is not charged. Check engine indicator light is on. Engine switch is OFF. No fuel. Stale gasoline or water in gasoline. Lubricant level is low.  Fuel valve is OFF. Spark plug faulty, fouled, or improperly gapped. Engine stored without treating or draining gasoline, or refueled with bad gasoline. Dirty fuel filter.	Charge the battery. Contact a qualified service center. Turn engine switch to ON. Fill fuel tank. Drain entire system and refill with fresh fuel. Check engine lubricant level and fill, if necessary. Turn fuel valve ON. Replace spark plug.  Drain fuel and carburetor. Refuel with fresh gasoline. Replace fuel filter or contact a qualified service center.
Engine hard to start.	Water in gasoline. Weak spark at spark plug.	Drain entire system and refill with fresh fuel. Replace spark plug or contact a qualified service center.
Engine lacks power.	Dirty air filter.  Engine stored without treating or draining gasoline, or refueled with bad gasoline.	Check air filter element. Clean or replace as needed. Drain fuel and carburetor. Refuel with fresh gasoline. If problem continues, contact a qualified service center.
Electric start feature not working.	Battery wires are disconnected. Battery is not charged. Engine battery charge circuit fuse is blown.	Connect the battery wires. Charge the battery. Replace the engine battery charge circuit fuse.
AC receptacle does not work.	Circuit breaker is tripped. GFCI is tripped. Item plugged in is defective.	Reset the AC circuit breaker. Reset the GFCI. Try a different item.
Generator makes a "spark knock" or "pinging" noise.	An occasional light "knocking" or "pinging" under heavy load is not a cause for concern. However, if the knocking or pinging occurs under normal load at a steady engine speed, the problem may be with the brand of gasoline being used.	Switch to a different brand of gasoline, making sure that the octane rating is 86 or higher. If problem continues, contact a qualified service center.

If problem persists after trying the above solutions, contact customer service or a qualified service center for assistance.

NOTICE:

As the equipment owner, you are responsible for the performance of the required maintenance listed in the Maintenance section. It is recommended that you retain all receipts covering maintenance on your equipment. Neglecting or failing to perform the required maintenance may increase emissions, decrease fuel efficiency, degrade performance, cause irreversible engine damage and/or void your warranty.

Make the most of your purchase! Go to [www.ryobitools.com](http://www.ryobitools.com) and register your new tool online. For questions about operating or maintaining your product, please call 1-800-860-4050.

