



Thank you for purchasing RYOBI™ Phone Works™

If you need assistance
DO NOT RETURN TO THE STORE
Please contact us at 1-877-578-6736

This app is optimized for: iOS versions 6.0 and higher · Android versions 4.0 and higher
For a full list of compatible phones please visit www.ryobitools.com/phoneworks

ES1500 LASER POINTER/TRANSFER LEVEL IMPORTANT SAFETY INSTRUCTIONS

⚠ WARNING!

READ AND UNDERSTAND ALL INSTRUCTIONS. Failure to follow all instructions listed below, may result in electric shock, fire and/or serious personal injury.

⚠ WARNING:

Changes or modifications to this unit not expressly approved by the party responsible for compliance could void the user's authority to operate the equipment.

⚠ WARNING:

Use of controls, adjustments, or performance of procedures other than those specified here can result in hazardous radiation exposure.

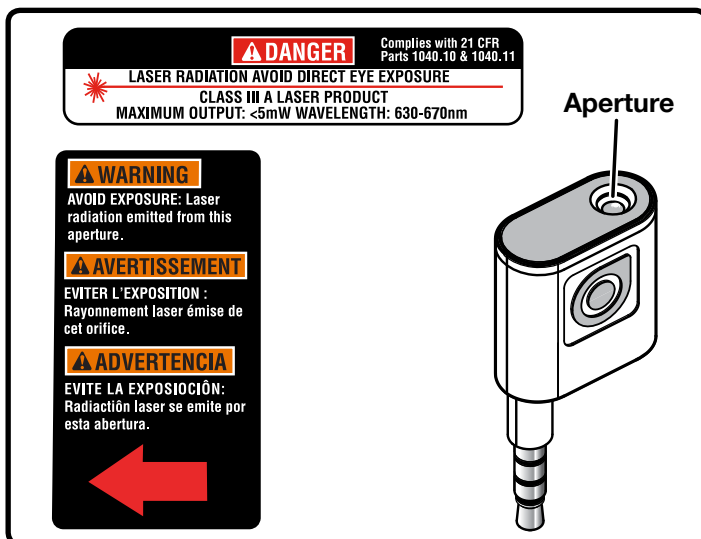

- **Read operator's manual carefully. Learn the applications and limitations, as well as the specific potential hazards, related to this device.** Following this rule will reduce the risk of electric shock, fire, or serious injury.
- **Do not disassemble the device.** Contact with internal parts may increase the risk of electric shock or cause damage to the device.

- **Do not use on a ladder or unstable support.** Stable footing on a solid surface enables better control of the device in unexpected situations.
- **Do not store the device in an area of high heat or humidity. Do not expose the device to extended high heat from the sun (such as on a vehicle dashboard.) To reduce the risk of serious personal injury, do not store outside or in vehicles.** Damage to the device or the battery can result.
- **Do not expose device to rain or wet conditions.** Water entering a device will increase the risk of electric shock.
- **Use the device in accordance with these instructions and in the manner intended for the device, taking into account the environmental conditions and the work to be performed.** Use of the device for operations different from those intended could result in a hazardous situation.
- **The laser used in this product is Class IIIa (3R) with < 5mW and 630-670nm wavelengths.**
- **Avoid direct eye exposure when using the laser and do not project the laser beam directly into the eyes of others.** Serious eye injury could result.
- **Do not place the instrument in a position that may cause anyone to stare into the laser beam intentionally or unintentionally.** Serious eye injury could result.
- **Do not operate the laser product around children or allow children to operate the tool.** Serious eye injury could result.
- **Always turn the laser product off when not in use.** Leaving the tool on increases the risk of someone inadvertently staring into the laser beam.
- **Do not operate the instrument in combustible areas such as in the presence of flammable liquids, gasses, or dust.**
- **Always ensure the laser beam is aimed at a surface without reflective properties.** Shiny reflective materials are not suitable for laser use.
- **The laser beam shall be used and maintained in accordance with the manufacturer's instructions.**
- **Never aim the laser beam at a person or object other than the target surface.**
- **Handle the instrument with care.** Treat it as you would any other optical device such as a camera or binoculars.
- **Avoid exposing the instrument to shock, continuous vibration, or extreme hot or cold temperatures.** Damage to the product and/or serious injury to the user could result.





SYMBOLS

The following signal words and meanings are intended to explain the levels of risk associated with this product.

SYMBOL	SIGNAL	MEANING
	DANGER:	Indicates an imminently hazardous situation, which, if not avoided, will result in death or serious injury.
	WARNING:	Indicates a potentially hazardous situation, which, if not avoided, could result in death or serious injury.
	CAUTION:	Indicates a potentially hazardous situation, which, if not avoided, may result in minor or moderate injury.
	NOTICE:	(Without Safety Alert Symbol) Indicates important information not related to an injury hazard, such as a situation that may result in property damage.

Some of the following symbols may be used on this product. Please study them and learn their meaning. Proper interpretation of these symbols will allow you to operate the product better and safer.

SYMBOL	NAME	DESIGNATION/EXPLANATION
	Safety Alert	Indicates a potential personal injury hazard.
	Read Operator's Manual	To reduce the risk of injury, user must read and understand operator's manual before using this product.

FEATURES

Laser Certifications: Class IIIa <5mW, 630-670 nm

- Find horizontal levels
- Find flat levels

- Flash **SOS** distress signal
- Identify and highlight objects from a distance



LEVEL MODE

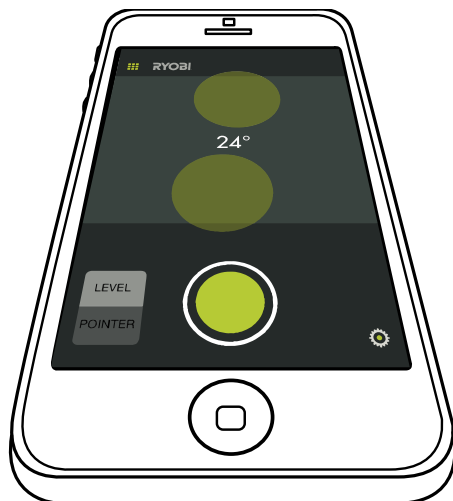

LEVEL MODE

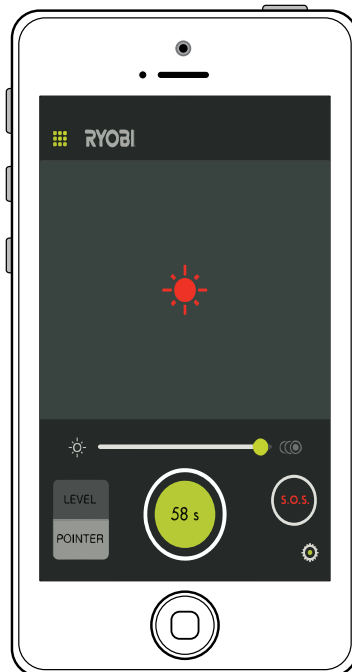

POINTER MODE

ICON	DESCRIPTION / FUNCTION
	Main RYOBI™ Phone Works™ app home screen
	When the leveling circles are aligned, the unit is perfectly flat.
	Angle reference
	Switch between level and pointer mode
	Laser ON and OFF

ICON	DESCRIPTION / FUNCTION
	Settings
	Reference level line
	Reference angle
	Laser beam indicator
	Auto-off slider
	Tap to flash an SOS distress signal.

ASSEMBLY

⚠ WARNING:

Do not use this product if it is not completely assembled or if any parts appear to be missing or damaged. Use of a product that is not properly and completely assembled or with damaged or missing parts could result in serious personal injury.

⚠ WARNING:

Do not attempt to modify this product or create accessories not recommended for use with this product. Any such alteration or modification is misuse and could result in a hazardous condition leading to possible serious personal injury.

If any parts are damaged or missing, please call 1-877-578-6736 for assistance.

OPERATION

Connecting The Laser Pointer/Transfer Level To Your Smartphone:

See Figure 1

- Select and open the RYOBI™ Phone Works™ app.
- Insert the laser pointer/transfer level into your smartphone's headphone jack.
- Open the LASER POINTER app segment.
- The user must read the Laser Radiation DANGER that appears on the screen. The app will not become active until the user taps **OK** at the bottom right of the screen.
NOTE: The user must tap **OK** any time this screen appears before operating the device.

Using The Laser Pointer/Transfer Level

Turn the volume on your smartphone to its maximum setting. Some phones have features that limit the amount of volume available. Turn these features off before you attempt to use the device.

To use the device as a laser pointer:

See Figure 2.

- Press “pointer” on the **mode selector**.
- Point the laser device directly at the target object. Tap the **laser on/off button** to activate the laser.

⚠ DANGER:

Avoid direct eye exposure when using the laser and do not project the laser beam directly into the eyes of others. Serious eye injury could result.

- The laser will automatically shut-off in 60 seconds.
NOTE: Turn the auto-off setting OFF and move the **auto-off slider** completely to the left to use the laser continuously. Turn the auto-off setting ON and move the slider to the right to set a laser shut-off time of up to 60 seconds.
- Press the **SOS button** to flash an SOS signal.
NOTE: When the button is pressed, the laser beam and laser beam indicator will begin to blink. This feature **DOES NOT** contact emergency services.

App images may vary.

Fig. 1

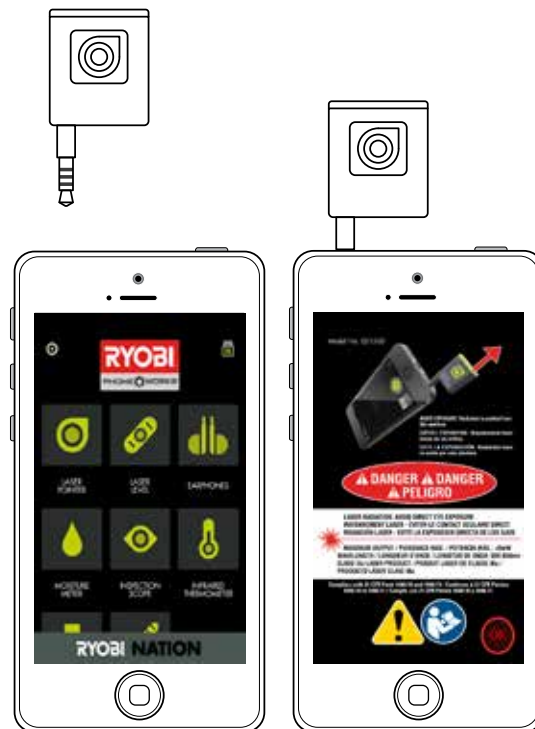
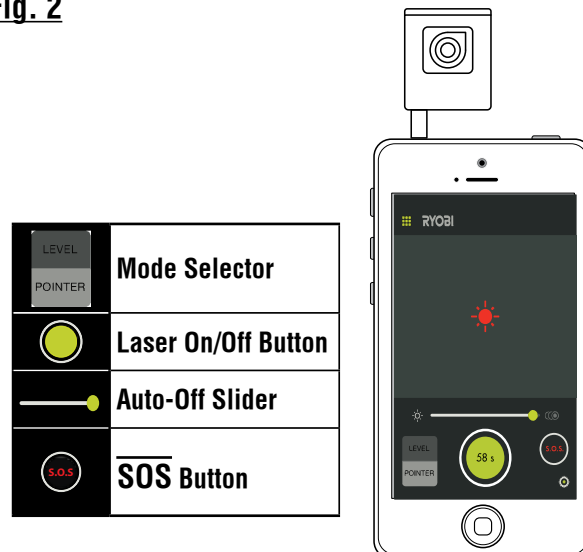

Fig. 2



OPERATION

To use the device as a transfer level:

See Figures 3 - 4.

- Press “level” on the **mode selector**.
- To obtain a flat level, place your smartphone on the surface you want to reference and tilt it until the **leveling circles** are aligned.
- To obtain a horizontal level, hold your smartphone upright or sideways and tilt it until the **reference angle** is at 0°.

NOTE: Depending on your device’s settings, the laser beam may turn on or blink when level is achieved.

Global Settings/Settings

See Figure 5.

- Tap the **Settings** icon on the RYOBI™ Phone Works™ home screen to make changes based on your preferences.
- Settings specific to some app segments can only be changed within the app segment.
- Tap **Save** to apply changes.
- You may also **LOGOUT** from this screen, view the Terms and Conditions, and view the Privacy Policy.

Fig. 3

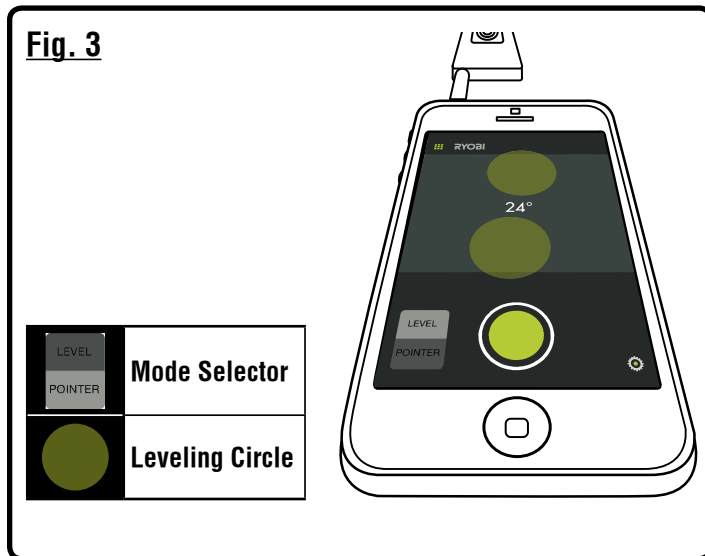

Fig. 4

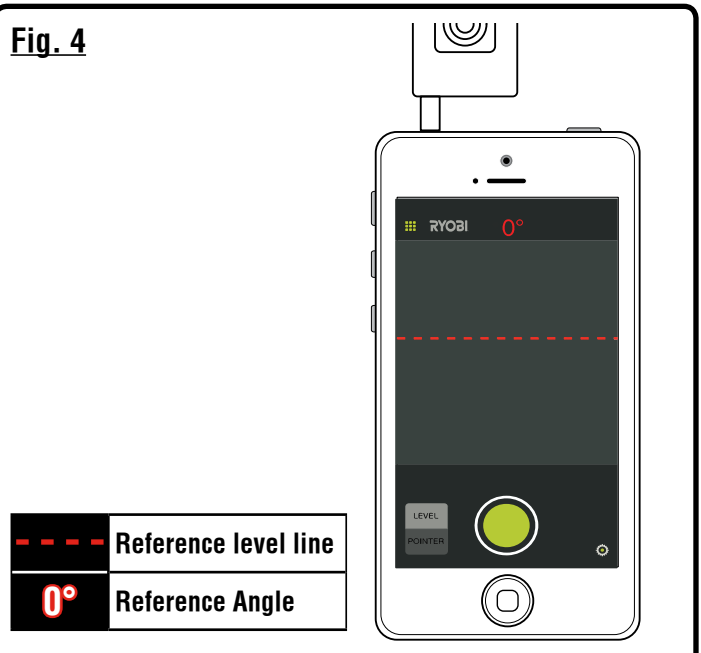
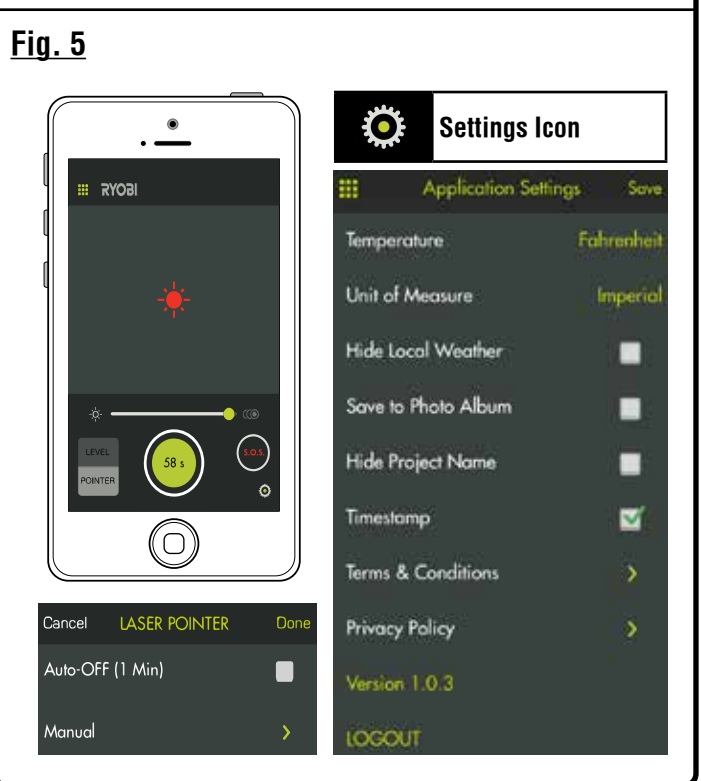

Fig. 5



MAINTENANCE

WARNING:

When servicing, use only identical replacement parts. Use of any other parts could create a hazard or cause product damage.

GENERAL MAINTENANCE

Avoid using solvents when cleaning plastic parts. Most plastics are susceptible to damage from various types of commercial

solvents and may be damaged by their use. Use clean cloths to remove dirt, dust, oil, grease, etc.

STORAGE

Store in a cool, dry location to prevent condensation or mold from forming inside the device.

Do not store the device at temperatures greater than 122° F (such as on a dashboard or vehicle interior).

CALIFORNIA PROPOSITION 65

WARNING:

This product may contain chemicals, including lead, known to the State of California to cause cancer, birth defects, or other reproductive harm. ***Wash hands after handling.***

WARRANTY

RYOBI™ Phone Works™ – LIMITED 1 YEAR WARRANTY

One World Technologies, Inc., warrants its RYOBI™ Phone Works™ products with the following conditions:

WHAT THIS WARRANTY COVERS: This warranty covers all defects in workmanship or materials in your RYOBI™ Phone Works™ for a period of one year from the date of purchase.

WHAT'S NOT COVERED: This warranty applies only to the original purchaser at retail and may not be transferred. This warranty only covers defects arising under normal usage and does not cover wearable parts, malfunction, failure or defects resulting from misuse, abuse, neglect, alteration, modification or repairs by other than RYOBI™ Phone Works™ Service Department. One World Technologies, Inc. makes no warranties, representations or promises as to the quality or performance of its power tools other than those specifically stated in this warranty.

HOW TO GET SERVICE: Return the RYOBI™ Phone Works™ Item to RYOBI™ Phone Works™ Service Department at the address below, freight prepaid. Insurance is required.

RYOBI™ Phone Works™ Service Department
1428 Pearman Dairy Road,
Anderson, SC 29625

When you request warranty service, you must also present proof of purchase documentation, which includes the date of purchase (for example, a bill of sale). We will repair any faulty workmanship, and either repair or replace any defective part, at our option. We will do so without any charge to you. We will complete the work in a reasonable time, but, in any case, within ninety (90) days or less.

For any additional questions or customer service please contact RYOBI™ Phone Works™ at 1-877-578-6736 or by logging on to www.ryobitools.com/phoneworks.

ADDITIONAL LIMITATIONS: Any implied warranties granted under state law, including warranties of merchantability or fitness for a particular purpose, are limited to three years from the date of purchase. One World Technologies, Inc. is not responsible for direct, indirect, or incidental damages, so the above limitations and exclusions may not apply to you. This warranty gives you specific legal rights, and you may also have other rights which vary from state to state.